

Galleria

Cnr Collier & Walter Roads, Morley WA 6062
 Telephone +61 8 9375 3228
galleriashoppingcentre.com.au

Galleria is a two-level major regional shopping centre located approximately 8kms north-east of the Perth CBD. Galleria is anchored by Myer, Target, Kmart, Coles, ALDI and Woolworths with a Greater Union cinema complex, and more than 165 specialty stores. The centre is a leading shopping and entertainment destination for Perth, offering a strong mix of fashion, food and fresh food shopping. Galleria provides local residents and families a convenient one-stop-shopping and dining experience.



Centre statistics

Centre type	Major Regional
Annual traffic (million)	9.3
Total GLA (sqm)	82,287
Total tenants	208
Majors ¹	Aldi, Coles, Kmart, Myer, Target, Woolworths, Greater Union
Mini Majors ²	Greg's Discount Chemist, Hans Café, Millers Fashion Club, Morley Fresh, Ozmosis, Rebel Sport, TEMT, Thingz Gifts
Number of specialty retailers ³	169
Number of car spaces	4,086
Moving annual turnover (MAT) (\$m) ⁴	495.7
MAT/sqm – Total (\$)	6,843
MAT/sqm – Specialty (\$) ⁵	10,449

Centre statistics correct as at 30 June 2018

- Classified in accordance with SCCA guidelines, typically includes supermarkets, department stores and discount department stores. Also includes Cinemas
- Stores >400 sqm, by Sales Group
- All sales reporting tenants under 400sqm, but excludes travel agents and lotto and free standing pads sites
- Total MAT includes all reporting tenancies and is inclusive of GST, as at 30 June 2018
- MAT/sqm - Based on sales and area for all reporting tenants, non-retail tenants excluded, as at 30 June 2018

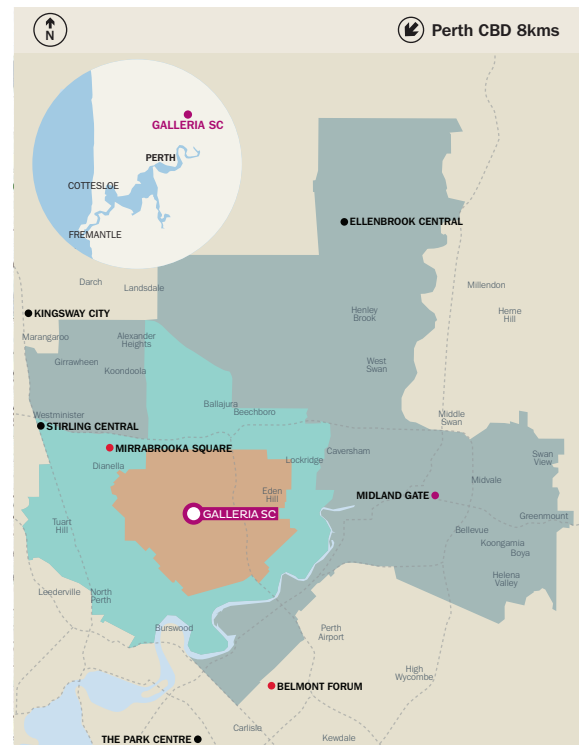

● PRIMARY
■ SECONDARY
■ TERTIARY
● MAJOR REGIONAL CENTRE
● REGIONAL CENTRE
● SUB REGIONAL CENTRE

Key statistics

8km

From the CBD

417,124

People in TTA

169

Specialty stores

Source: Produced by Vicinity Data Science & Insights. This material is a derivative of ABS Data that can be accessed from the website of the Australian Bureau of Statistics at www.abs.gov.au.
 TTA: Total Trade Area

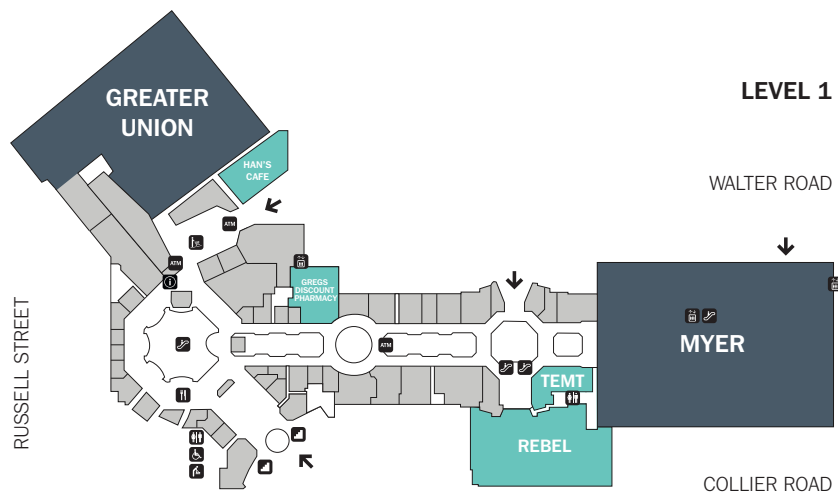
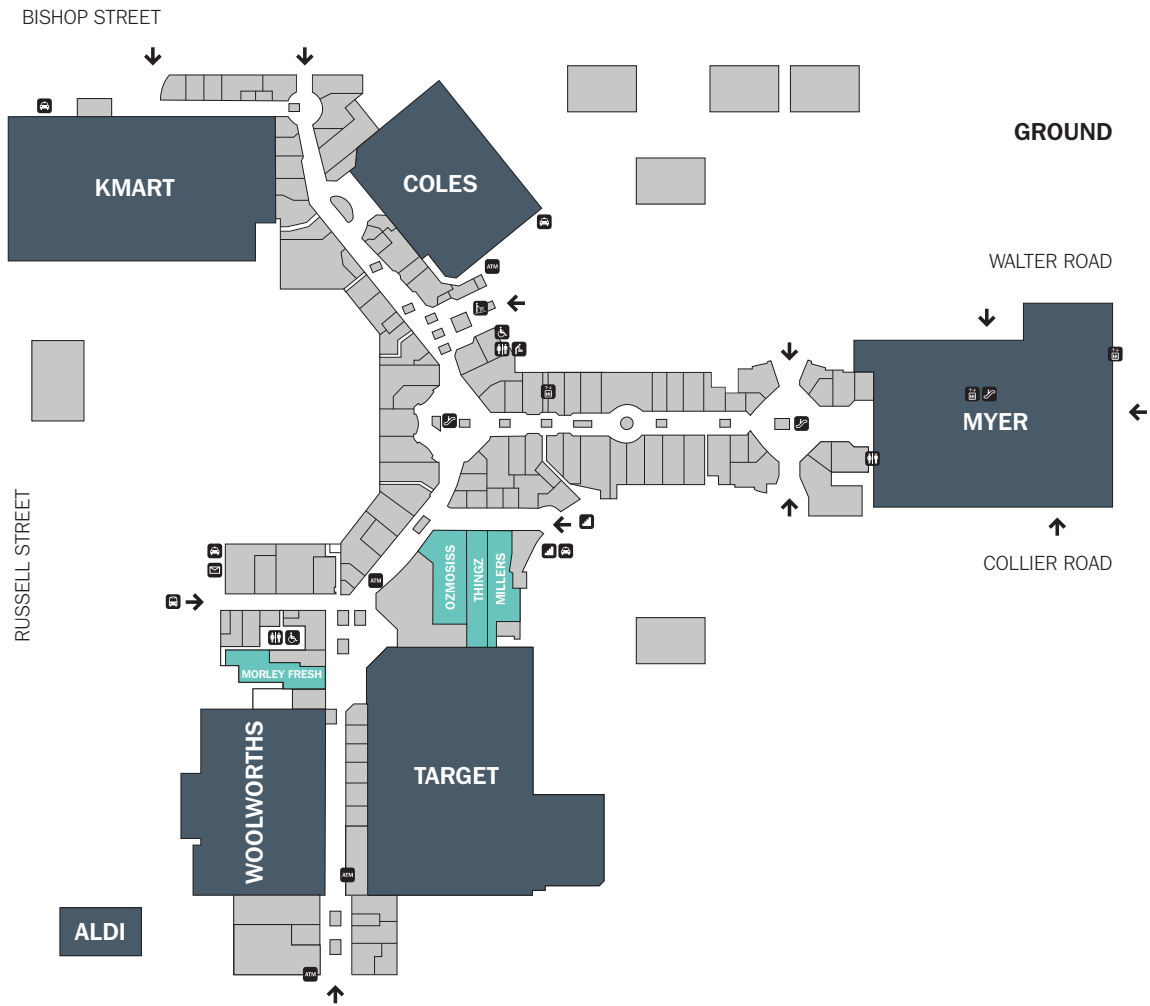

- MAJORS
- MINI MAJORS
- SPECIALTIES
- ENTRANCES →

Floor plan as at 30 June 2018.

For further information please contact:

Vicinity Centres

Level 4, Chadstone Tower One, 1341 Dandenong Road , Melbourne VIC 3148
 Telephone +61 3 7001 4000, Facsimile +61 3 7001 4001

Disclaimer
 Information contained in this document is based on historical data and is illustrative only. It does not provide any predictions as to future events or outcomes and does not constitute a lease offer or warranty as to the profitability, design or layout of the centre. You should carry out your own investigations and satisfy yourself in that regard and obtain independent legal, financial and business advice before making any decision or entering into any agreement or arrangement concerning the subject matter of this document or the centre. The information is provided on the clear understanding that while care has been taken in its preparation, to the extent permitted by law, all liability for omissions or errors however arising is expressly disclaimed. Vicinity Centres may amend, add or remove any information in this document at any time without further notice to you. You may not copy or use any part of this document without the express written consent of Vicinity Centres. Any monetary amounts are expressed in Australian dollars unless otherwise stated. Rates are subject to change without notification.