

The Myer Centre Brisbane

91 Queen Street, Brisbane QLD 4000
 Telephone +61 7 3223 6900, Facsimile +61 7 3003 1217
myercentreshopping.com.au

The Myer Centre is a six-level shopping centre located in the heart of Brisbane's CBD on Queen Street Mall. The centre is located above an underground bus interchange, which is Brisbane's busiest transport hub. The centre is anchored by the largest Myer store in Queensland plus Target, Event Cinemas, Coles Central and over 145 specialty stores. The Myer Centre is an iconic CBD retail destination and convenient go-to centre for city workers and families, offering a selection of well-known brands and major retailers under the one roof. A development is expected to commence in FY20.



Centre statistics

Centre type	City Centre
Annual traffic (million)	31
Total GLA (sqm)	63,708
Total tenants	169
Majors ¹	Coles Central, Event Cinemas, Myer, Target
Mini Majors ²	Beach House Bar & Grill CBD, Best & Less, Daiso, Laura Ashley, Lincraft, Terry White Chemists
Number of specialty retailers ³	146
Number of car spaces	1,450
Moving annual turnover (MAT) (\$m) ⁴	n.a.
MAT/sqm – Total (\$)	n.a.
MAT/sqm – Specialty (\$) ⁵	n.a.

Centre statistics correct as at 30 June 2018

- Classified in accordance with SCCA guidelines, typically includes supermarkets, department stores and discount department stores. Also includes Cinemas
- Stores >400 sqm, by Sales Group
- All sales reporting tenants under 400sqm, but excludes travel agents and lotto and free standing pads sites
- Total MAT includes all reporting tenancies and is inclusive of GST, as at 30 June 2018
- MAT/sqm - Based on sales and area for all reporting tenants, non-retail tenants excluded, as at 30 June 2018

Key statistics

Central

Located in the CBD

2,203,888

People in TTA

151

Specialty stores

Source: Produced by Vicinity Data Science & Insights. This material is a derivative of ABS Data that can be accessed from the website of the Australian Bureau of Statistics at www.abs.gov.au.
 TTA: Total Trade Area



LEVEL 4

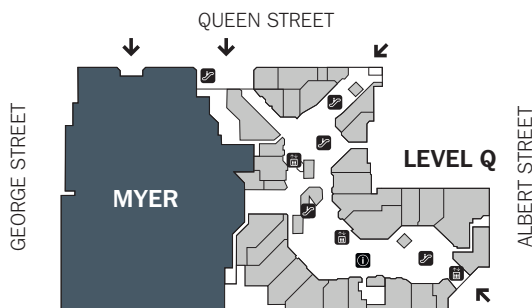

ELIZABETH STREET

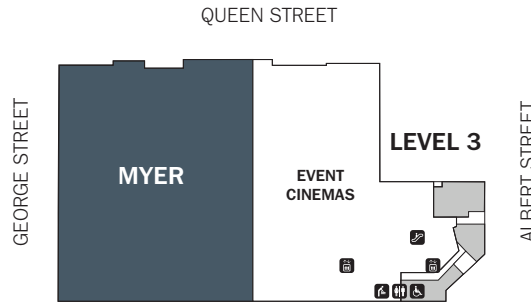

ELIZABETH STREET

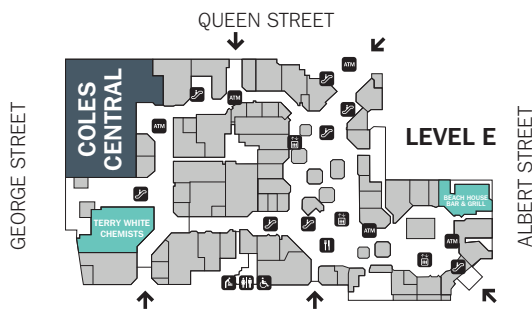

ELIZABETH STREET

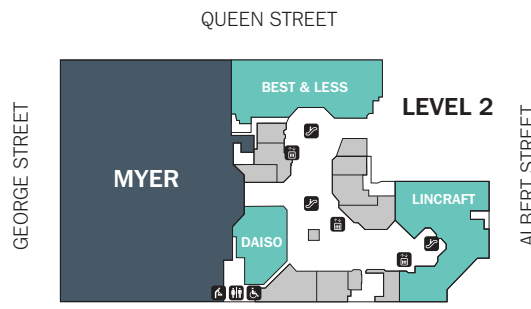

ELIZABETH STREET

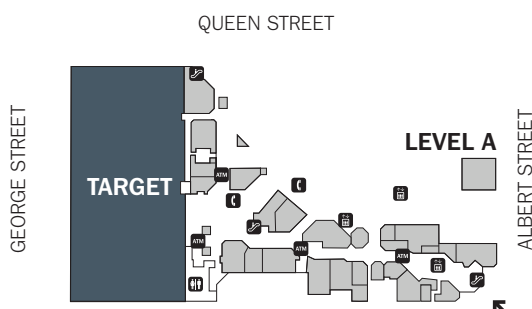

ELIZABETH STREET

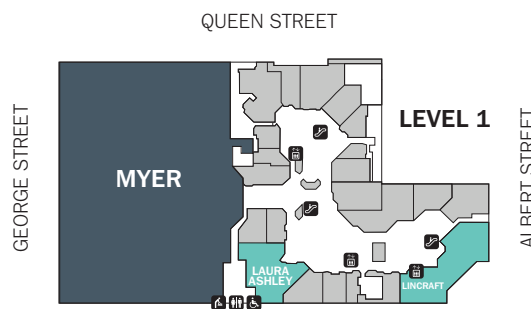

ELIZABETH STREET

- MAJORS
- MINI MAJORS
- SPECIALTIES
- ENTRANCES →

Floor plan as at 30 June 2018.

For further information please contact:

Vicinity Centres

Level 4, Chadstone Tower One, 1341 Dandenong Road , Melbourne VIC 3148
 Telephone +61 3 7001 4000, Facsimile +61 3 7001 4001

Disclaimer
 Information contained in this document is based on historical data and is illustrative only. It does not provide any predictions as to future events or outcomes and does not constitute a lease offer or warranty as to the profitability, design or layout of the centre. You should carry out your own investigations and satisfy yourself in that regard and obtain independent legal, financial and business advice before making any decision or entering into any agreement or arrangement concerning the subject matter of this document or the centre. The information is provided on the clear understanding that while care has been taken in its preparation, to the extent permitted by law, all liability for omissions or errors however arising is expressly disclaimed. Vicinity Centres may amend, add or remove any information in this document at any time without further notice to you. You may not copy or use any part of this document without the express written consent of Vicinity Centres. Any monetary amounts are expressed in Australian dollars unless otherwise stated. Rates are subject to change without notification.